

SMART GSM/GPRS REMOTE CAMERA

Security Wireless USER MANUAL

MODEL: MMS1000

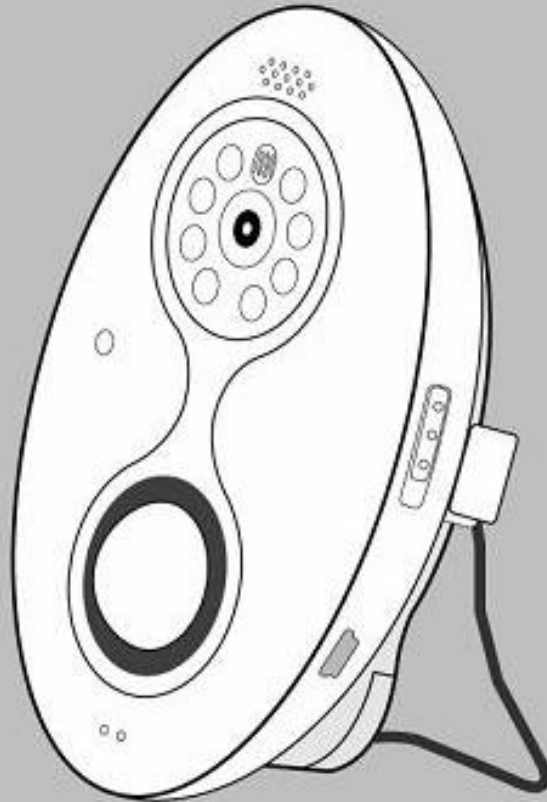

CONTENTS

MMS1000	1
For Your Safety	2
Chapter 1 Product Features	3
Chapter 2 MMS1000 Host Instruction	4
Indicator Status Instruction	5
SIM Card Installation	5
Chapter 3 Quick Start.....	6
3.1 Start Up.....	6
3.2 Arming/Disarming	7
3.3 Timer arming/disarming.....	7
3.4 Remote Capture.....	7
3.5 Alarm	8
3.6 Voice Monitor	8
3.7 Language.....	8
3.8 Status Inquires.....	8
3.9 Help.....	8
Chapter 4 Maintenance.....	9
Chapter 5 Troubleshooting	10
Appendix: SMS command list.....	11

Thank you for purchasing the MMS1000!

MMS1000 is a smart *GSM/GPRS* remote camera. It helps you achieve remote monitor, alarm and shooting, and thus provides a safe solution for protecting your privacy. You can freely ask the device to take photos and send to your mobile phone or mailbox in slide show by phone call or SMS command any time anywhere. With the built-in IR lights, it can take high resolution images even in dark environment.

When anybody break in, it can trigger aware immediately, then take photos and send to you automatically, in this way, your privacy safety and security can be effectively protected!

All functions and service are supported by the GSM network and SIM card. For detailed operation and product functions, please read this user manual carefully.

2

For your safety



Please make sure the GSM SIM card PIN code de-activated, and caller ID presentation & MMS service activated.

Please do remember and keep the password and SIM card number secret.

◆ For Your Safety

Keep it away from signal interference.

Do not use it in any explosive places.

Please use the original power adapter to avoid any damage.

Keep it out of the reach of children

◆ Declaration

The information contained in this manual has been carefully checked and is believed to be accurate. However, Montnets assumes no responsibility for any inaccuracies that may be contained herein.

In no event will Montnets, be liable for any direct, indirect, special, incidental, or consequential damages resulting from any defect or omission in this manual, even if advised of the possibility of such damages.

In the interest of continued product development, Montnets reserves the right to make improvements to this manual, and the products described herein, at any time without notice or obligation.

Chapter 1

Product Features

■ Product Features

1. All GSM SIM cards can be used, capable of sending photos taken to MMS service enabled mobile phone or mailbox.
2. Integrated PIR sensor to provide precise and timely alarm
3. Built-in CMOS camera and IR lights: it can take clear images at night
4. Phone call and SMS central: You can remote control the Camera by phone call or SMS command.
5. Two-way communication: You can listen to the voice of monitoring place, and your voice can be broadcasted via built-in speaker.
6. Multi-mode alarm: It can alarm by SMS, MMS, E-mail and Phone call.
7. Schedule monitor: It can timer arm or monitor as the preset scheduler.
8. Backup battery: Built-in Lithium battery ensures operation for power failure.
9. Easy installation: Wireless connection, it can be installed anywhere.

Product Accessories

■ Product Accessories



Camera
(1 unit)



Power adapter
(1 PC)



User manual
(1 PC)

Chapter 2

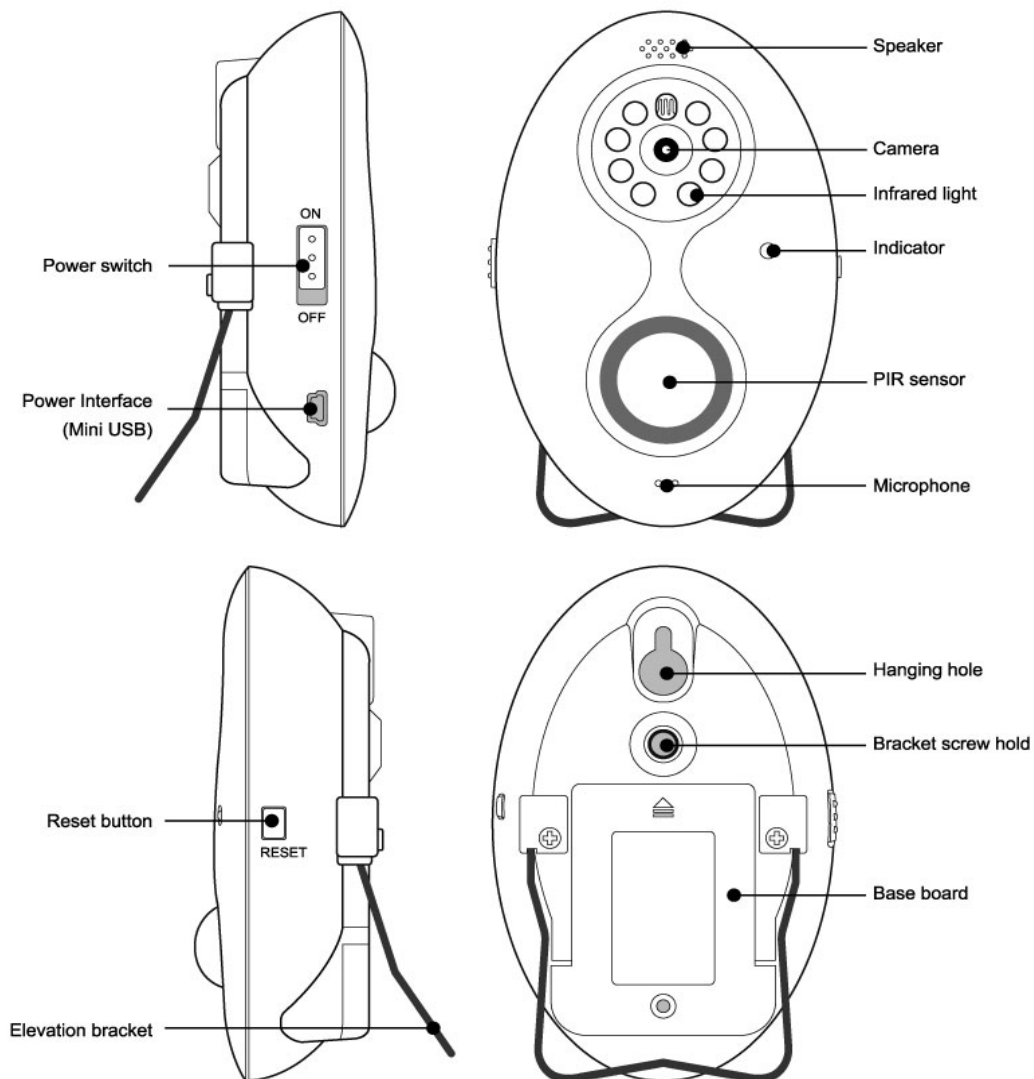
MMS1000 Host Instruction

■ Indicator Status Instruction

Indicator Status Instruction

Color	Indicator	Status
Red	Flash slowly	Searching the network
	Flash quickly	PIR sensor alarm
	Constant Light	No SIM card or malfunction
Green	Constant Light	Arming status
	Flash slowly	Disarming status
	Flash quickly	Disarming status
	Light two seconds	Restored to factory settings Note: Turn on the camera. When the indicator lights on, press the RESET button until the indicator turns green, it will restore to factory settings.

Note:

1. Slow flash: Indicator flashes 1 time per second; Quick flash: Indicator flashes 2 times per second.
2. The indicator light can be enabled or disabled by pressing the RESET button for more than 10seconds when in normal status

■ SIM Card Installation

- **Note: MMS1000 supports GSM SIM cards only. Please make sure the caller ID presentation and MMS service is activated. For more info, refer to your SIM card provider.**

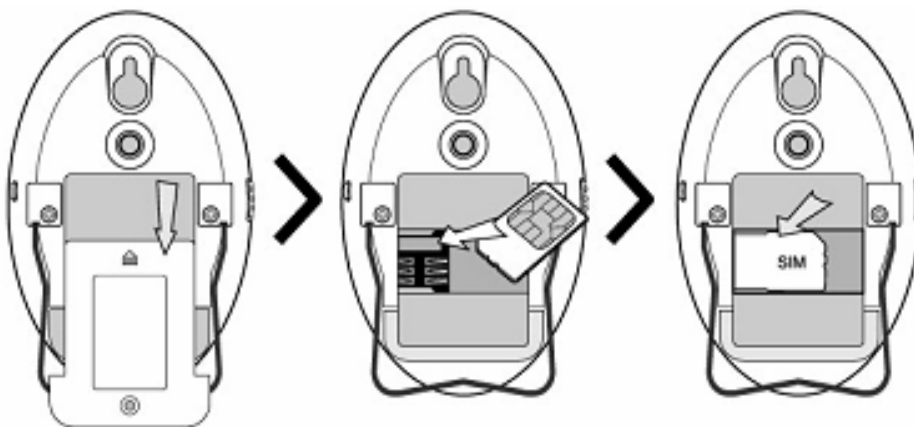

Remove the cover and take the battery. Slide the SIM card into its holder with the contacts facing down as shown in the picture. Insert the battery and then replace the cover.

Chapter3

Quick start

About the SMS Command:

- 1) All SMS commands are composed of symbols # and Arabic numerals.
- 2) SMS command format of master and family users: #code#content#.
- 3) Password is four-digit numbers, default to 1234.
- 4) The maximum digit of phone number is 16.
- 5) When SMS command received, it will automatically reply.

Note:

1. The symbol “#” is necessary for the SMS command, but no space character included.
2. Two or more SMS commands can be sent in one SMS, separated by semicolon in English.
3. The maximum length of SMS parameters is 50 characters or digits.



■ 1. Start Up

Set the master before you use this device or when restored to factory settings, i.e. to let it recognize the master phone number, so that it can send alarm SMS to the master automatically. There are two methods as follows:

Method 1: Make a call with your mobile phone, and you will hear it hung up.

Method 2: Send the SMS command to start up: #00#

After starting up, you will receive a SMS reply:

Welcome! Congratulations on your purchase of MMS1000! You are authorized to use this device. Password: 1234.

■ 2. Arming / Disarming

To arm the device is to activate the alarm function, thus the PIR sensor turns to working state. To disarm the device is to deactivate the alarm function, the PIR sensor turns to off working state. There are following two methods:

Method 1:

Send the SMS command to arm: #01#

You will receive the SMS reply "Armed successfully" and the indicator will turn green.

Send the SMS command to disarm: #02#

You will receive the SMS reply "Disarmed successfully", and the indicator will turn to slow green flash

Method 2:

Make a call to the device via master number or family number, hang up in 5~20 seconds when you hear the ring tone, and it will automatically switch the arming / disarming status.

Note: If the arming/disarming status repeatedly switched, you will receive the SMS reply "Armed/Disarmed already".

■ 3. Timer arming/disarming

To timer arm the device is to activate the alarm function at a preset time.

Send the SMS command to timer arm: #128#1#

Send the SMS command to timer disarm: #128#0#

■ 4. Remote Capture

Method 1: Make a call to the device via master number or family number, hang up in 5 seconds when you hear the ring tone, and you will receive the SMS reply "Your request has been received, the device is sending image(s) now", and then MMS reply followed.

Method 2: Send the SMS command:

Master/family users: #03#Image number#

Guest: #03#Password#Image number#

And you will receive the SMS reply "Remote capture request received, the device is sending image(s) now", and then MMS reply followed.

Note: If image size set to 160*128 or 320*240, you can ask for 8 images at most, i.e. 1~8 optional. If image size set to 640*480, you can ask for 2 images at most, i.e. 1~2 optional.

■ 5. Alarm

With the built-in PIR sensor, the device can alarm once triggered, default to SMS and MMS. If alarm SMS, MMS and call activated at the same time, it will send alarm SMS and MMS orderly and then make phone calls, once for each. For alarm calls, it will dial the master number first, and then family numbers until answered. If no answer for even 3-cycle calling, then it will give up.

■ 6. Voice Monitor

Make a call to the device via master or family numbers until answered, and you can hear the voice of monitoring area.

■ 7. Language

There are two versions of language available, send a SMS command (for master only):

Chinese version: #127#1#

And you will receive the SMS reply "Language switched to English."

■ 8. Status Inquiries

You can ask the device for the present settings and working status, send a SMS command as follows and you will receive a reply with all details (password not included):

Master and family users: #07#

Guest: #07# password#

■ 9. Help

You can ask the device for help, send a SMS command as follows and you will receive a reply with command list or user manual:

For SMS command:

Master or family users: #09#

Guest: #09# password#1#

9 Chapter 4 Maintenance

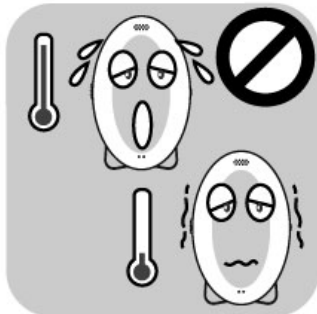

Please use and store this product in suitable temperature. Keep it away from excessive moisture and extreme temperatures.



Please clean it with soft moist cloth, do not use alcohol, Acetone or other solvents.



Please keep the camera and all accessories dry. Keep it away from water or any liquid.



Please refer to trouble shooting for problems solution. Do not uninstall it yourself. For other problems, contact the dealers.



Keep it away from dust.

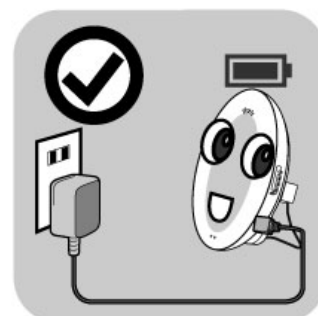

Please charge the battery for more than 12 hours to ensure optimum battery performance before your first use. Charge it for 4 hours every 3 month if you don't use it.

10 Chapter 5 Troubleshooting

No.	Problem	Possible Reason	Solution
1	Indicator light does not work	The indicator lights disabled	Press the RESET button for 10s or send SMS command
2	Start up failure (Indicator works normally)	Master already set	Restore to factory settings
3	Functions failure, but indicator works normally	Caller ID presentation or MMS service deactivated, overdue	Contact the operator
4	Indicators remain on red	No SIM card, or poor/wrong contact	Power off, check the SIM card and restart in 2s.
5	Operation failure	malfunction	Power off, check the SIM card and restart in 2s. Or restore to factory settings
6	After start up, indicators remain flash red	Weak signal or network busy	Power off and restart in another place with stronger signal
		SIM card PIN code activated	Remove the PIN code
		Invalid SIM card	Check the SIM card status with the operator
		Do not bind a master user to the device	Bind a master user to the device
7	Failed to power on with external power after long time supply of battery	Battery over discharged	Charge the battery for 1 hour, power off and then restart

Note: If the problem can't be solved with the above guidelines, please contact your local dealer or after sales center.

11 Appendix: SMS command list

Password is necessary for guest only in the SMS command, default to 1234.

User	Function	SMS Command
Master	Start the device	#00#
		Refer to Chapter 3, Quick start, 1.Start up
Master/family	Arm the device	#01#
		Refer to Chapter 3. Quick start, 2. Arming/Disarming
	Disarm the device	#02#
		Refer to Chapter 3. Quick start, 2. Arming/Disarming
Master/family/guest	Capture MMS Image	#03#password#image number#
		Refer to Chapter 3, Quick start, 4.Remote Capture
Master	Change password	#04#old password#new password#
Master	Add family number	#06#family number#
		You are allowed to add up to 10 different family numbers.
Master/family/guest	Status Inquiries	#07#
		#07#password#
		Refer to Chapter 3, Quick start, 8.Status Inquiries
Master	Restore to factory settings	#08#password#
		4-digit password
Master/family / guest	SMS command/User Manual	#09#password#
		#09#password#1#
		Refer to Chapter 3 Quick start, 9.Help
Master/family	Deactivate SMS alarm	#11#0#
	Activate SMS alarm (Default)	#11#1#
Master/family	Deactivate MMS alarm	#12#0#
	Activate MMS alarm (Default)	#12#1#
Master/family	Deactivate call alarm (Default)	#13#0#
	Activate call alarm	#13#1#
Master	Change master number	#14#new master number#
		16-digit max

12 Appendix: SMS command list

User	Function	SMS Command
Master/family/ guest	Send MMS capture to appointed mobile number	#30#password#mobile number#image number#
Master/family	Disable IR lights	#31#0#
	Enable IR lights	#31#1#
Master/family/ guest	Change image size	#32#value#
		Value 1: 160×128 2: 320×240 (QVGA default) 3: 640×480 (VGA) For example: #32#1# means auto alarm image size is 160*128.
Master/family	Change alarm image number	#33#number#
		Number: 2~8 optional, default to 5. If image size is 640*480, the number can be 1~2 only.
Master/family	Set image brightness	#34#value#
		The value can be:1,2,3,4,5 (from 1 darkest to 5 brightest), default to 4
Master/family	Set Image contrast	#38#value#
		The value can be:1,2,3,4,5 (from lowest to highest), default to 4
Master/family	Set interval of image capture	#103#time#
		Interval can be 3~10 (unit is 0.1second), default to 5
Master/family	Add or modify E-mail address.	#108#EMAIL#
		Only one email address for one user
	Delete E-mail	#109#Email address#

13 Appendix: SMS command list

User	Function	SMS Command
Master/family	Deactivate MMS alarm to E-mail	#110#0#
	Activate MMS alarm to E-mail	#110#1#
Master/family	Delete family user	#113# <i>family user</i> #
		Note: Specify the family user you want to delete, for #113# means delete all the family users.
Master/family	Activate MMS timer sending	#115#1#
	Deactivate MMS timer sending	#115#0#
Master/family	Set time periods of MMS timer sending scheduler	#116#day#period1 start time # period 1 end time#period1 interval#period2 start time#period2 end time#period 2 interval#period3 start time#period3 end time#period3 interval# For example, #116#1#0800#1200#1430#1630#30# means during 8 AM to 12 AM and 2:30 PM to 4:30 PM of every Monday, the device will auto send out a MMS image in every 30 minutes.
		<p>day: (one digit, 0-8)</p> <p>0 means everyday; 3 means Wednesday;</p> <p>8 means from Monday to 4 means Thursday;</p> <p>Friday;</p> <p>1 means Monday; 5 means Friday;</p> <p>2 means Tuesday; 6 means Saturday;</p> <p>7 means Sunday.</p> <p>Start time-end time: (4 digits, 24 hours, such as 0000 means 00:00AM, 2359 means 11.59 PM)).</p> <p>Interval time: (1-3 digits, 1-480, means sending MMS image interval, the unit is minute) 1-480 minutes interval.</p>

14 Appendix: SMS command list

User	Function	SMS Command
Master/family	Activate PIR sensor	#118#1#
	Deactivate PIR sensor	#118#0#
Master/family	Set MMS center	#124#MMS center#
Master/family	Set APN parameter	#125#gateway IP#gateway port#APN#APN user name#APN password#
Master/family	Change language	#127#value#
		0 means Chinese, 1 means English
Master/family	Timing arm the device	#128#value#
		Refer to Chapter 3, Quick start, 3. Timer arming/disarming
Master/family	Set timer arming scheduler	#129#day#period 1 arm time#period 1 disarm time#period 2 arm time#period 2 disarm time#period 3 arm time#period 3 disarm time#
		For day, arm time and disarm time, refer to the illustration of "Set time periods of MMS timer sending scheduler"
Master/family	Disable/Enable indicator	#143#value#
		The value can be 0 or 1, 0 means disable the indicator, 1 means enable the indicator, default to 1
Master/family	Deactivate power switch SMS alert	#144#0#
	Activate power switch SMS alert	#144#1#
Master/ family	Set MMS sending way	#148#value#
		Value 1 means MMS sent by Http, Value 0 means MMS sent by WAY
Master/ family	Deactivate/activate the speaker	#164#value#
		Value 0 means to deactivate, Value 1 means to activate
Master/ family	Regulate device time	#152#number#
		Note: The number is the device SIM number. This command is used to regulate device time.

I am always here!

To protect your privacy safety and
security anytime anywhere!

Security Wireless

Addr.: 5 Vinstra Road, Valhalla, Pretoria, 0185

Tel.: +27 12 654 7895

Fax: +27 86 633 5065

E-mail: info@securitywireless.co.za

Website: www.securitywireless.co.za